

linkagency



68 The Old Sidings  
St John's Court, Goole, DN14 6FS  
£725 PCM





# 68 The Old Sidings, St John's Court, Goole, DN14 6FS

Spacious two bedroom ground floor apartment, in a new development, tucked into a quiet corner, close to the centre of Goole. Built with the future in mind down to every detail. Insulated throughout to standards beyond minimal requirement. Wild flower garden can be enjoyed by all occupants and has outdoor furniture as well as diving trellis to allow privacy. Occupants benefit from the added security of CCTV and all apartments have the the ability to connect to ultra-fast broadband. Gas central heating.

The property briefly comprises; entrance hall with storage cupboards, open-plan lounge and kitchen with high gloss units, integrated oven, gas hob and extractor plus space for white goods, two good size bedrooms and modern bathroom with wash basin, WC and bath with overhead shower.

The development has allocated parking bays for residents.

A holding deposit of £167.00 is payable on application.

Please register your interest to view the property via the tenant registration form on our website.



## Area Map

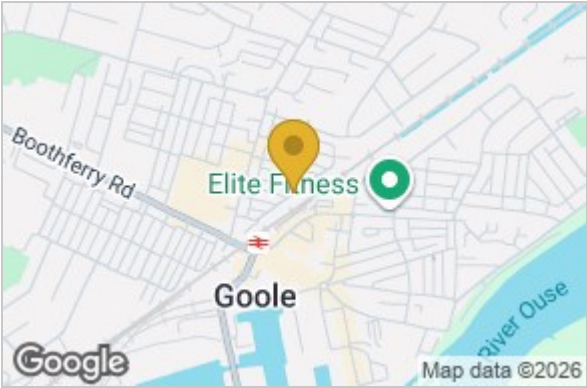

## Floor Plan

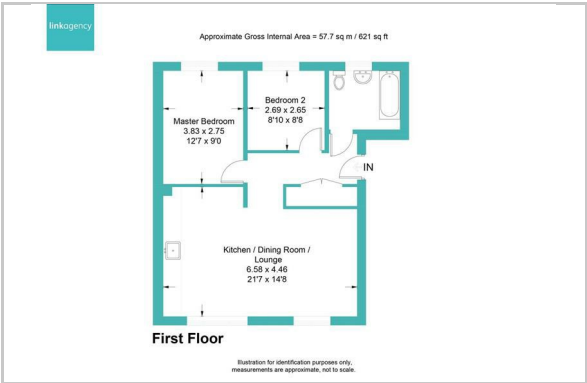

## Energy Efficiency Graph

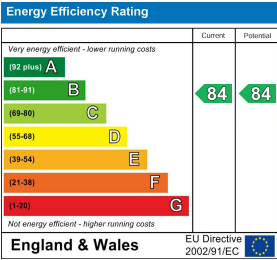

These particulars, whilst believed to be accurate are set out as a general outline only for guidance and do not constitute any part of an offer or contract. Intending purchasers should not rely on them as statements of representation of fact, but must satisfy themselves by inspection or otherwise as to their accuracy. No person in this firms employment has the authority to make or give any representation or warranty in respect of the property.